

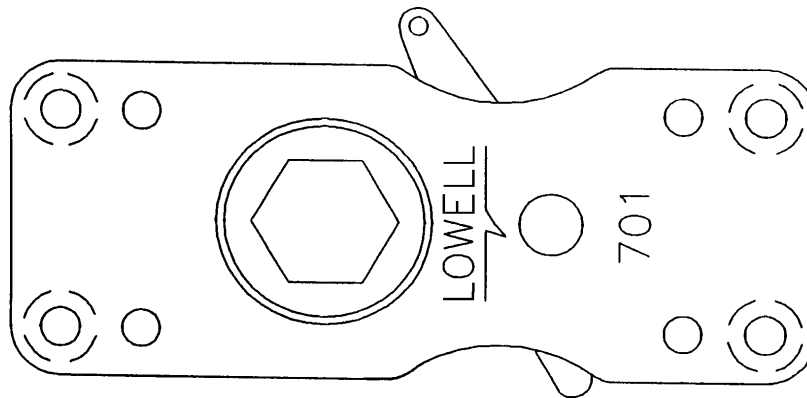

Lowell Series 700 Ratchet Clutch



Applications:

- Backstopping
- Overrunning
- Coupling
- Indexing

Benefits:

- Reversible
- High drive torque to weight ratio
- Maximum driving efficiency
- Minimal overrunning torque
- Versatile mounting options
- Can be used singularly or in combination
- Alignment is noncritical



65 Hartwell St., West Boylston, MA, 01583
Ph # 508/835-2900 Fax # 508/835-2944
Toll free # 800/456-9355
www.lowellcorp.com

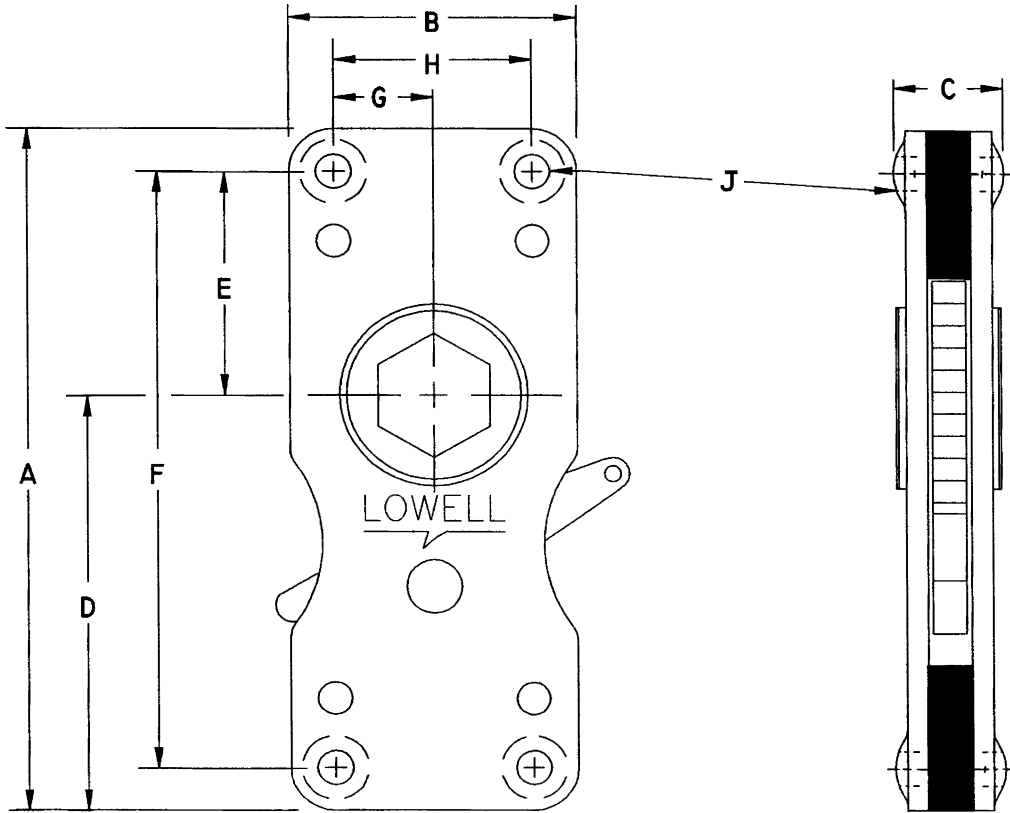

SERIES 700 BODY DIMENSIONS (in inches)

Model	A	B	C	D	E	F	G	H	J	Gear teeth	Weight
701	4"	1-5/8	21/32	2-7/16	1-21/64	3-1/2	9/16	1-1/8	3/16	16	10 oz
702	5-1/4"	2-3/8	61/64	3-5/8	1-1/4	4-1/2	13/16	1-5/8	17/64	20	1-1/2 lbs

AVAILABLE SHAFT OPENINGS (in inches)

Model	3/8			7/16			1/2			9/16			5/8			3/4			7/8			1			
	B	H	S	B	H	S	B	H	S	B	H	S	B	H	S	B	H	S	B	H	S	B	H	S	
701			X		X		X	X	X		X		X	X	X	X	X								
702							X	X	X		X	X	X	X	X	X	X	X	X	X		X	X		

Lowell introduces the Series 700 reversible ratchet clutch. Two sizes are available with a variety of shaft opening shapes and sizes from which to choose. The large tooth-pawl engagement area makes the Series 700 reversible ratchet clutch incredibly strong for its light weight and small size. The sides of the unit have been left open for easy maintenance.

65 Hartwell St., West Boylston, MA, 01583
 Ph # 508/835-2900 Fax # 508/835-2944
 Toll free # 800/456-9355
www.lowellcorp.com

